

Filters, Series «C»

Ports 1/4", 3/8", 1/2", 1"

Compact (modular) with metal bowl and bayonet-type mounting



General data

construction	compact, with sintered bronze filtering element			
materials	aluminium body, aluminium bowl, Grillamid sight glass, NBR seals			
threaded ports	1/4"	3/8"	1/2"	1"
max. condensate capacity	28	85	85	380 cm ³
weight	0.314	0.420	0.410	1.400 kg
type of mouting	vertical in-line or wall-mounting			
operating temperature	0 - 60°C at 10 bar			
porosity of filtering element	25 μ standard; 5 μ (upon request)			
draining of condensate	semi-automatic, standard			
finish	enamelled			

Pneumatic data

operating pressure	0,3 - 1,6 bar			
nominal flow	see graph			

The filters in the compact series are available with 1/4", 3/8", 1/2" and 1" ports.
The bowls of these filters are made of metal with a transparent viewer and incorporate a semi-automatic drain.

Coding of filters

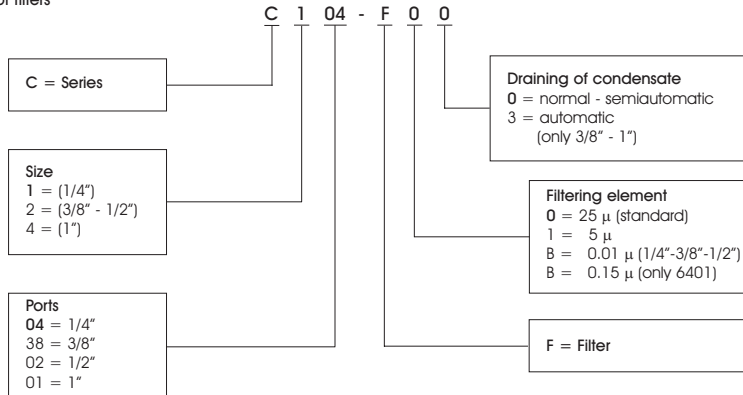

Note: for 1/4", 3/8", 1/2", 0 refers to both the manual and semiautomatic models.

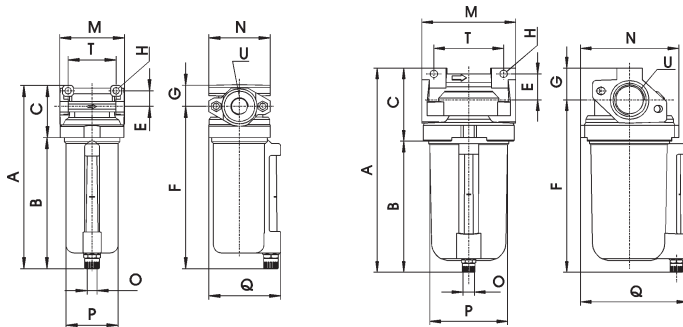
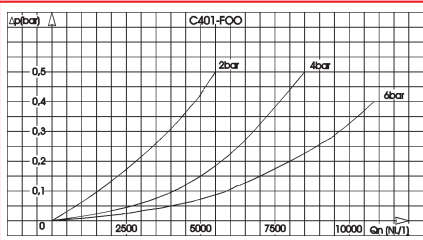
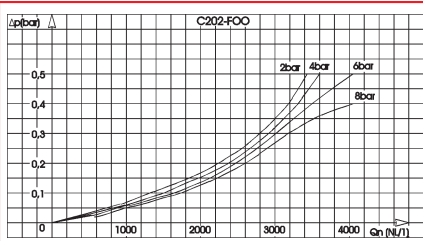
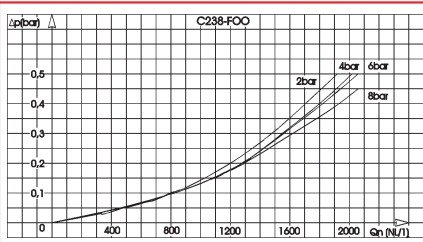
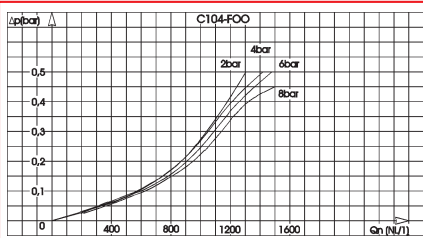

Mod. C104 - F00
C238 - F00
C202 - F00

Mod. C401 - F00

Mod.	A	B	C	E	F	G	H	M	N	O	P	Q	T	U
C104 - F00	136	96	40	11	121	15	5	45	45	1/8"	34	53	35	1/4"
C238 - F00	176	126	50	15	156	20	6	62	59	1/8"	50	69	46	3/8"
C202 - F00	176	126	50	15	156	20	6	62	59	1/8"	50	69	46	1/2"
C401 - F00	228	146	82	29	193	35	8	105	110	1/4"	87	120	78	1"

The company reserves the right to vary models and dimensions without notice.

Pressure regulators, Series «C»

Ports 1/4", 3/8", 1/2", 1"
Compact (modulator)



General data

construction	compact, diaphragm-type			
materials	aluminium body, nylon knob grip, NBR seals			
threaded ports	1/4"	3/8"	1/2"	1"
weight	0.316	0.470	0.460	2.200 kg
pressure gauge ports	1/8"	1/8"	1/8"	1/4"
type of mouting	in-line, wall or console mounting (in any position)			
operating temperature	0 - 60°C			
finish	enamelled			

Pneumatic data

inlet pressure	0 - 16 bar
outlet pressure	0.5 - 10 bar
nominal flow	see graph
secondary pressure relieving	standard

The pressure regulators are available with 1/4", 3/8", 1/2" and 1" connections. Normally they are available with secondary pressure relieving. Apart from the 1" version, all the other versions can be panel mounted.

6

Coding of regulators

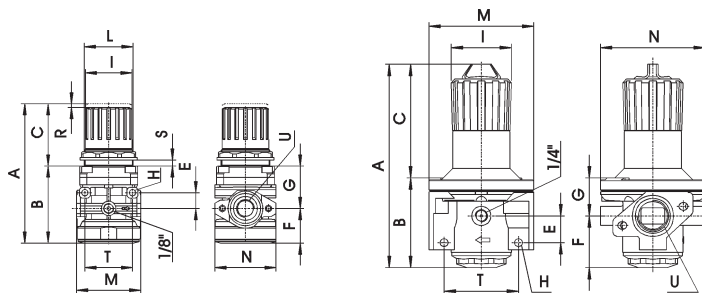
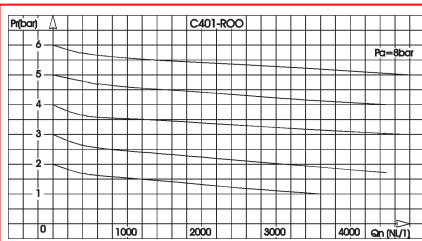
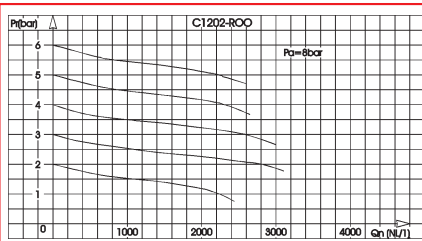
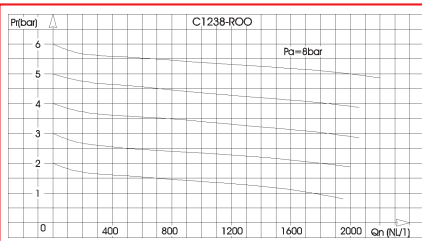
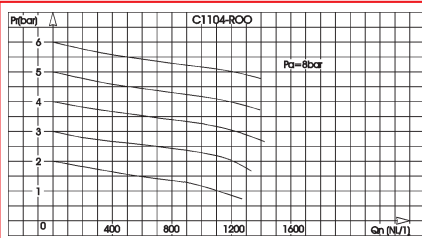
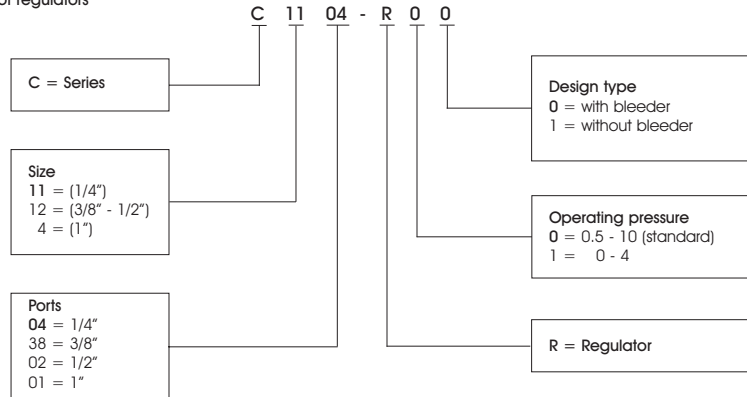

Mod. C1104 - R00
C1238 - R00
C1202 - R00

Mod. C401 - R00

Mod.	A	B	C	E	F	G	H	I	L	M	N	R	S	T	U
C1104 - R00	94	55	39	11	28	28	5	28	30x1.5	45	45	3	0-6	35	1/4"
C1238 - R00	134	75	59	15	34	41	6	45	47x1.5	62	59	3.5	0-9	46	3/8"
C1202 - R00	134	75	59	15	34	41	6	45	47x1.5	62	59	3.5	0-9	46	1/2"
C401 - R00	213	94	119	28	54	40	8	63	—	110	110	—	—	78	1"

Lubricators, Series «C»

Connections 1/4", 3/8", 1/2", 1"

Compact (modular) with metal bowl and bayonet-type mounting



General data

construction	compact, with compensation valve			
materials	aluminium body, aluminium bowl, Grillamid viewer, NBR seals			
threaded ports	1/4"	3/8"	1/2"	1"
oil capacity	37	130	130	455 cm ³
weight	0.342	0.430	0.420	1.400 kg
type of mounting	vertical in-line or wall-mounting			
operating temperature	-10° - 60°C at 10 bar			
oil refilling	(1/4") only when depressurized (3/8" - 1/2" - 1") during use even when pressurized			
oil for lubrication	from 3° - 10° E (ask our engineers for types)			
finish	enamelled			

Pneumatic data

operating pressure	0 - 16 bar					
nominal flow	see graph					
minimum air consumption for lubrication	(Nl/min.)	1/4"	3/8"	1/2"	1"	
		5	4	4	25	
		at 6 bar	8	8	9	60

The lubricators in the compact Series are available with 1/4", 3/8", 1/2" and 1" ports.
The bowls of these lubricators are made of metal and are equipped with a transparent viewer. The oil flow can be monitored via the small transparent cap and regulated by means of the special adjusting screw.

Coding of lubricators

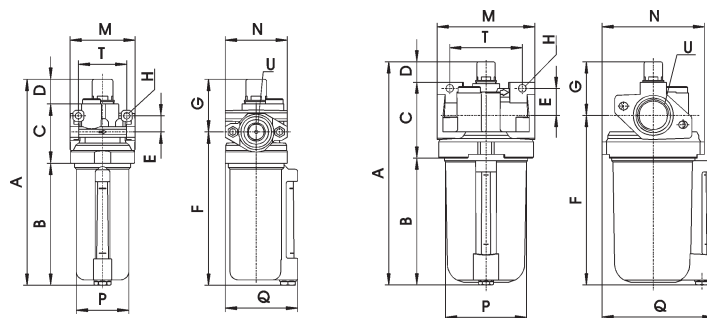
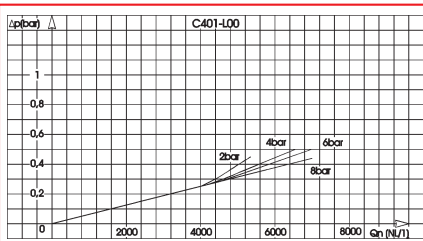
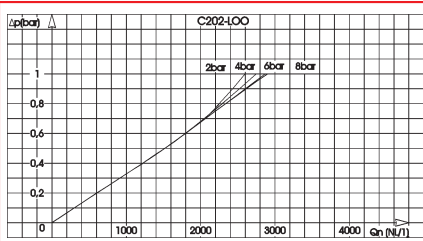
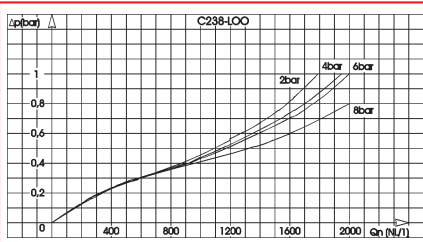
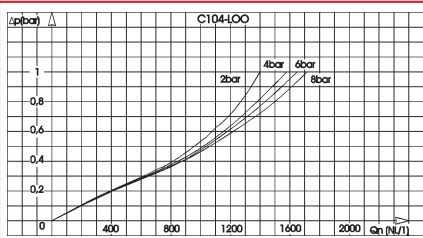
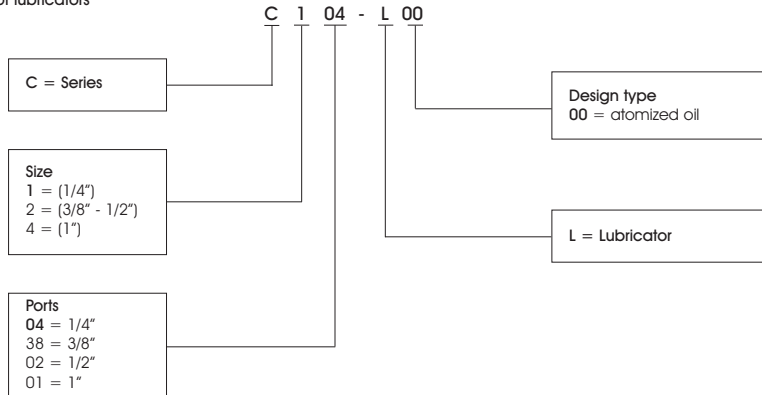

Mod. C104 - L00
C238 - L00
C202 - L00

Mod. C401 - L00

Mod.	A	B	C	D	E	F	G	H	M	N	P	Q	T	U
C104 - L00	157	95	48	24	11	110	47	5	45	45	34	53	35	1/4"
C238 - L00	195	115	56	24	15	145	50	6	62	59	50	69	46	3/8"
C202 - L00	195	115	56	24	15	145	50	6	62	59	50	69	46	1/2"
C401 - L00	239	135	82	22	29	181	58	8	105	110	87	120	78	1"

Lubricators, Series «C»

Connections 1/4", 3/8", 1/2", 1"

Compact (modular) with metal bowl and bayonet-type mounting



General data

construction	compact, with compensation valve			
materials	aluminium body, aluminium bowl, Grilamid viewer, NBR seals			
threaded ports	1/4"	3/8"	1/2"	1"
oil capacity	37	130	130	455 cm ³
weight	0.342	0.430	0.420	1.400 kg
type of mounting	vertical in-line or wall-mounting			
operating temperature	-10° - 60°C at 10 bar			
oil refilling	(1/4") only when depressurized (3/8" - 1/2" - 1") during use even when pressurized			
oil for lubrication	from 3° - 10° E (ask our engineers for types)			
finish	enamelled			

Pneumatic data

operating pressure	0 - 16 bar					
nominal flow	see graph					
minimum air consumption for lubrication	(Nl/min.)	1/4"	3/8"	1/2"	1"	
		5	4	4	25	
		at 6 bar	8	8	9	60

The lubricators in the compact Series are available with 1/4", 3/8", 1/2" and 1" ports.
The bowls of these lubricators are made of metal and are equipped with a transparent viewer. The oil flow can be monitored via the small transparent cap and regulated by means of the special adjusting screw.

Coding of lubricators

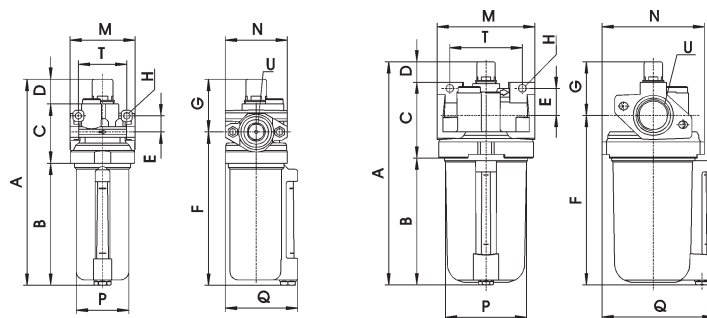
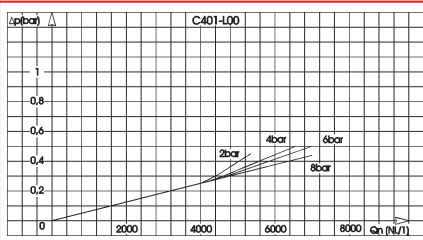
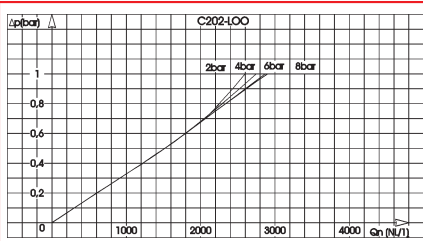
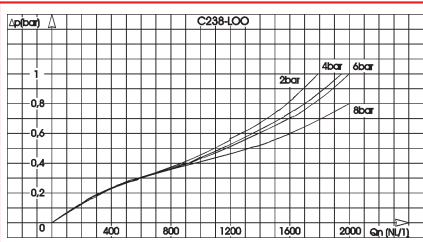
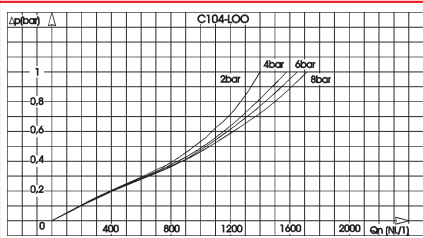
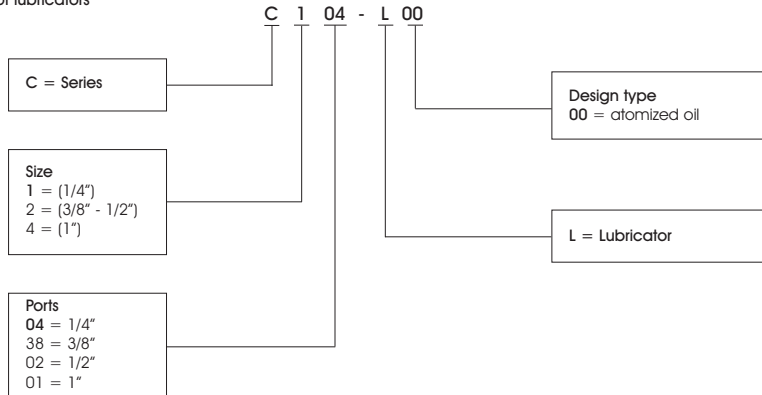

Mod. C104 - L00
C238 - L00
C202 - L00

Mod. C401 - L00

Mod.	A	B	C	D	E	F	G	H	M	N	P	Q	T	U
C104 - L00	157	95	48	24	11	110	47	5	45	45	34	53	35	1/4"
C238 - L00	195	115	56	24	15	145	50	6	62	59	50	69	46	3/8"
C202 - L00	195	115	56	24	15	145	50	6	62	59	50	69	46	1/2"
C401 - L00	239	135	82	22	29	181	58	8	105	110	87	120	78	1"

The company reserves the right to vary models and dimensions without notice.

Filter/regulator, Series «C»

Ports 1/4", 3/8", 1/2", 1"

Compact (modulator) with metal bowl and bayonet-type mounting



General data

construction	compact, with sintered bronze filtering element, diaphragm-type			
materials	aluminium body, aluminium bowl, Grillamid viewer, nylon knob			
	grip, NBR seals			
threaded ports	1/4"	3/8"	1/2"	1"
condensate capacity	28	85	85	380 cm ³
weight	0.440	0.706	0.704	3.000 kg
pressure gauge ports	1/8"	1/8"	1/8"	1/4"
type of mouting	vertical in-line or wall-mounting			
operating temperature	0 - 60°C at 10 bar			
porosity of filtering element	25 μ standard; 5 μ (available on request)			
drainage of condensate	standard semiautomatic, manual			
finish	enamelled			
Pneumatic data				
inlet pressure	0 - 16 bar			
outlet pressure	0.5 - 10 bar			
nominal flow	see graph			
secondary pressure relieving	standard			

The integrated regulator/filters are available with 1/4", 3/8", 1/2", and 1" ports. They combine the features of the filters and reducers and have smaller overall dimensions than the two separate components.

6

Coding of regulator/filter

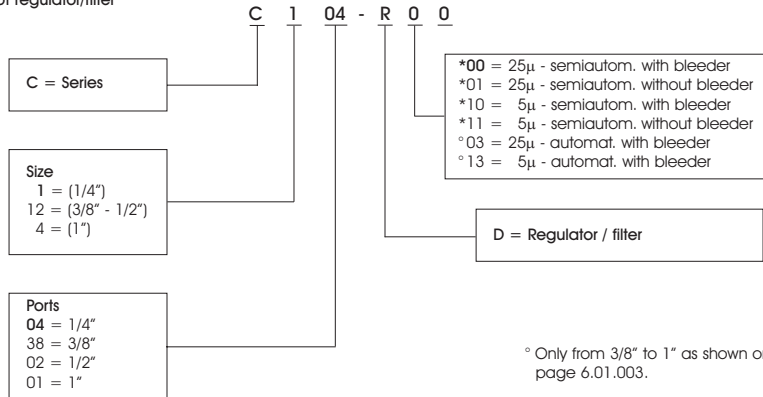

° Only from 3/8" to 1" as shown on page 6.01.003.

* Note: The exhaust is both manual and semiautomatic

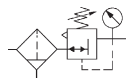
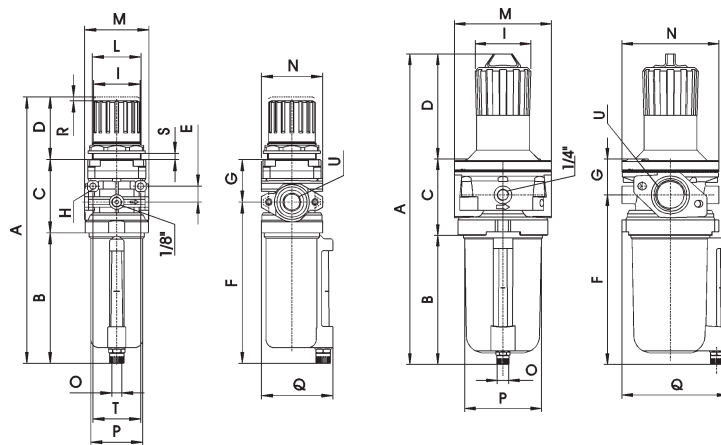
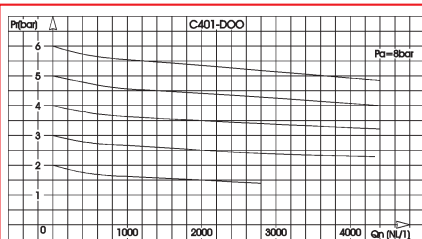
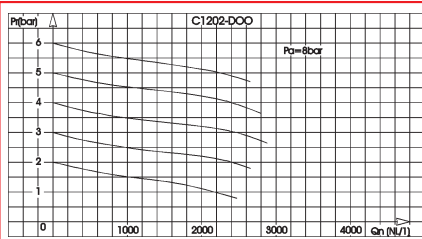
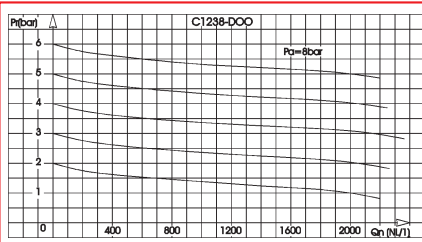
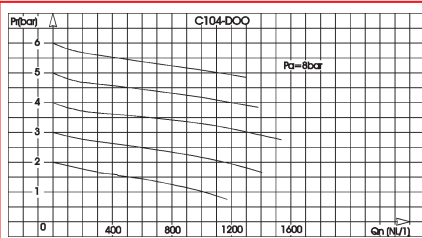

Mod. C 104 - D00
C1238 - D00
C1202 - D00

Mod. C401 - D00

Mod.	A	B	C	D	E	F	G	H	I	L	M	N	O	P	Q	R	S	T	U
C 104 - D00	187	96	52	39	11	120	28	5	28	30x1.5	45	45	1/8"	34	53	3	0-6	35	1/4"
C1238 - D00	257	127	71	59	15	157	41	6	45	47x1.5	62	59	1/8"	50	69	3.5	0-9	46	3/8"
C1202 - D00	257	127	71	59	15	157	41	6	45	47x1.5	62	59	1/8"	50	69	3.5	0-9	46	1/2"
C 401 - D00	357	146	87	124	—	193	41	—	63	—	110	110	1/4"	87	120	—	—	—	1"

Pressure regulator, Series «N»

Ports 1/8" - 1/4"
nipple-type



General data

construction	with nipples and diaphragm type
materials	OT58 brass body (nickel-plated); nylon knob grip; NBR seals
threaded ports	1/8" - 1/4"
weight	Kg 0.316
pressure gauge ports	1/8"
type of mounting	in-line or console (in any position)
operating temperature	0 - 80°C
Pneumatic data	
inlet pressure	0 - 16 bar
outlet pressure	0.5 - 10 bar
nominal flow	see graph
secondary pressure relieving	standard

Note: In the place of Mod. N204-R00, use Mod. M004-R00 (page 6.06.003)

The Series «N» pressure regulator is available with 1/4" and 1/8" gas ports. Its design incorporates a diaphragm and relieving so as to allow decremental adjustments as well. This compact regulator may be mounted directly on pipes or onto a console.

Coding of regulators

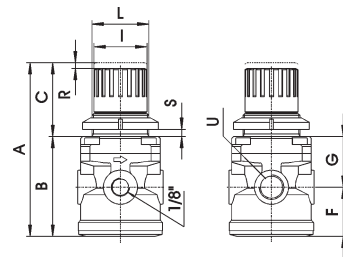
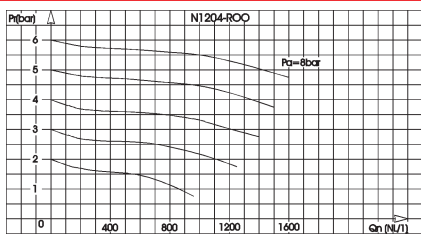
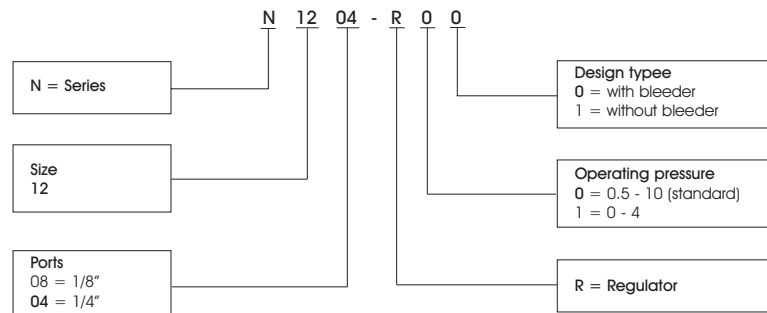

Mod.	A	B	C	F	G	I	L	M	N	R	S	U
N1208 - R00	92	53	39	26	27	28	30 x 1.5	45	45	3	0 - 6	1/8"
N1204 - R00	92	53	39	26	27	28	30 x 1.5	45	45	3	0 - 6	1/4"

Microregulator Series «M»

Ports 1/8" - 1/4"
nipple-type



General data

construction	with nipples and diaphragm type
materials	OT58 brass (nickel-plated); nylon knob grip; NBR seals
threaded ports	1/8" - 1/4"
weight	Kg 0.235
pressure gauge ports	1/8"
type of mounting	in-line or on console (in any position)
operating temperature	0-80°C

Pneumatic data

inlet pressure	0-16 bar
outlet pressure	0.5-10 bar
nominal flow	see graph
secondary pressure relieving	standard

The Series «M» pressure regulator is available with 1/8" and 1/4" gas ports. Its design incorporates a diaphragm and relieving so as to allow decremental adjustments as well. This regulator, which has very small dimensions, may be mounted directly on pipes or on a console.

Coding of regulators

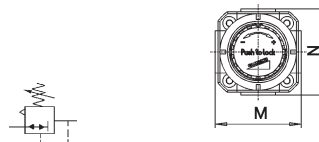
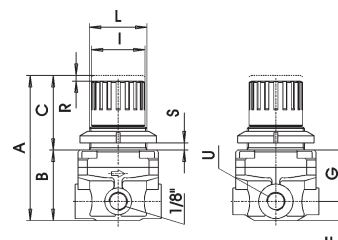
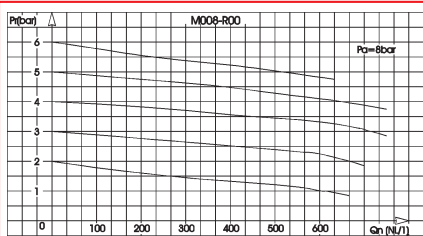
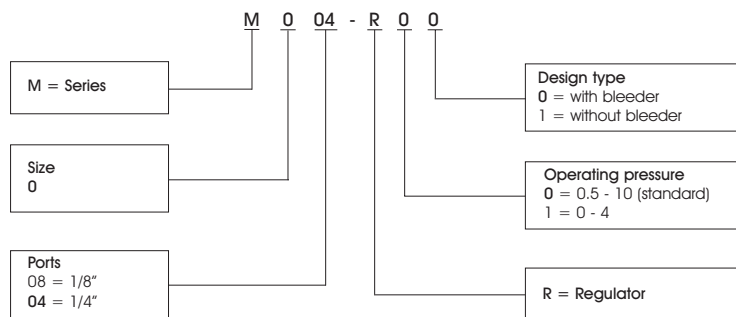

Mod.	A	B	C	F	G	I	L	M	N	R	S	U
M008 - R00	76	37	39	10	27	28	30 x 1.5	45	45	3	0 - 6	1/8"
M004 - R00	76	37	39	10	27	28	30 x 1.5	45	45	3	0 - 6	1/4"

Lubricator, Series «N»

Ports 1/8" - 1/4"

nipple-type, with screw-on transparent bowl



General data

construction	with nipples and compensation valve	
materials	OT58 brass body (nickel-plated), Tragomid bowl, Grillamid viewer, NBR seals	
threaded ports	1/8" - 1/4"	
weight	Kg 0.288	
oil capacity	26 cm ³ (size 1) 37 cm ³ (size 2)	
type of mouting	vertical, in-line	
operating temperature	-10 - 60°C at 10 bar	
oil refilling	without pressure	
oil for lubricator	from 3° ÷ 10° E (ask our engineers for types available)	
Pneumatic data		
operating pressure	0 - 16 bar	
nominal flow	see graph	
Min. air consumption for lubrication	at 1 bar = 6 NL/min	at 6 bar = NL/min

The Series "N" lubricator is available with 1/4" and 1/8" gas ports. The special type of design caters for a vast range of applications in relation to the amount of oil atomized and the air consumed. The body of the lubricator is made of OT58 brass, while the bowl is transparent.

Coding of lubricators

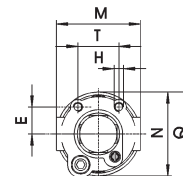
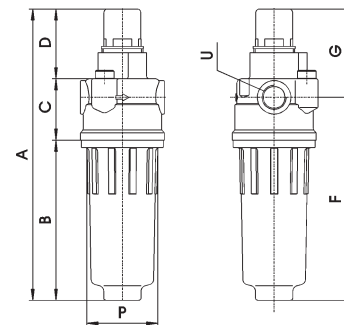
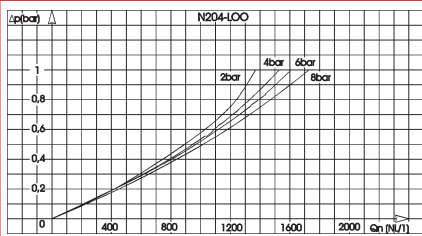
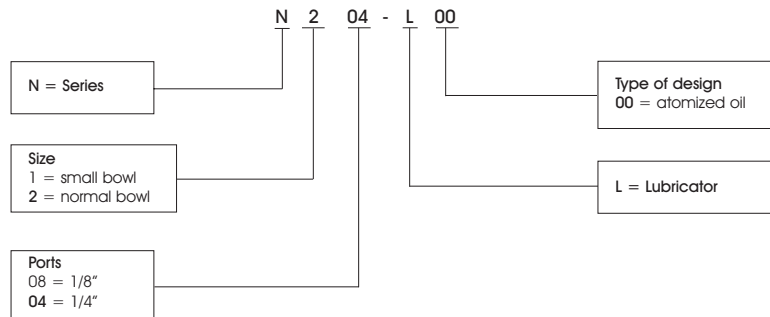

Mod.	A	B	C	D	E	F	G	H	M	N	P	Q	T	U
N108 - L00	133	62	33	38	14.5	85	48	M5	45	44.5	38	46	22	1/8"
N104 - L00	133	62	33	38	14.5	85	48	M5	45	44.5	38	46	22	1/4"
N208 - L00	157	86	33	38	14.5	109	48	M5	45	44.5	38	46	22	1/8"
N204 - L00	157	86	33	38	14.5	109	48	M5	45	44.5	38	46	22	1/4"

6

Pressure regulator/filter, Series «N»

Ports 1/8" - 1/4"

nipple-type, with screw-on transparent bowl



General data

construction	with nipples, and sintered bronze filtering element
materials	OT58 brass (nickel-plated); Grilamid bowl; nylon knob
	grip, NBR seals
threaded ports	1/8" - 1/4"
weight	Kg 0.370
max. condensate capacity	28 cm ³
pressure gauge ports	1/8"
type of mounting	vertical, in-line
operating temperature	0 - 60°C at 10 bar
porosity of filtering element	25 μ, standard; 5 μ, available on request
draining of condensate	standard semiautomatic, manual
Pneumatic data	
inlet pressure	0 - 16 bar
outlet pressure	0.5 - 10 bar
nominal flow	see graph
secondary pressure relieving	standard

The Series «N» regulator/filter is available with 1/4" and 1/8" gas ports. The regulator is of diaphragm type with Relieving. The filter bowl which is transparent allows easy monitoring of the condensate levels. The manual and semiautomatic drain makes both the manual and automatic condensate exhaust easier when there is no pressure.

Coding of regulator/filter

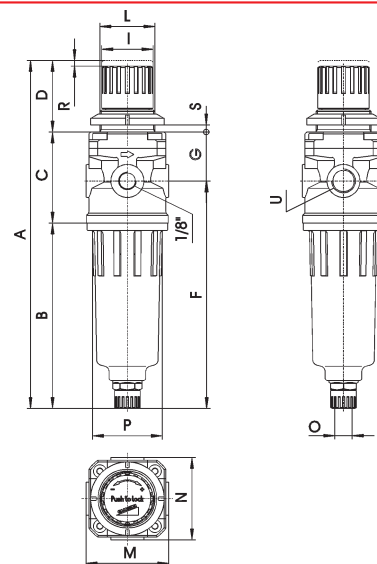
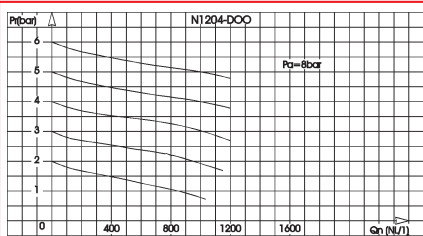
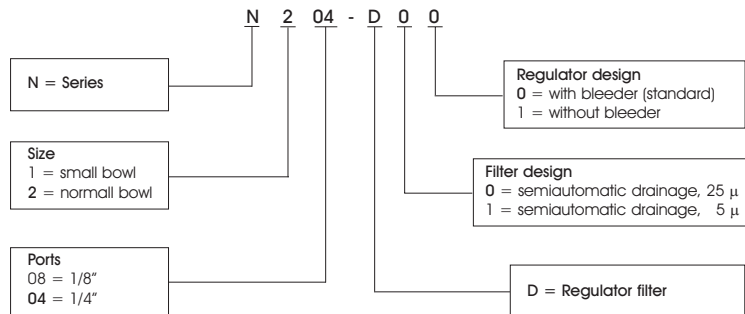

Mod.	A	B	C	D	F	G	I	L	M	N	O	P	R	S	U
N108 - D00	167	78	50	39	101	27	28	30 x 1.5	45	45	1/8"	38	3	0 - 6	1/8"
N104 - D00	167	78	50	39	101	27	28	30 x 1.5	45	45	1/8"	38	3	0 - 6	1/4"
N208 - D00	191	102	50	39	125	27	28	30 x 1.5	45	45	1/8"	38	3	0 - 6	1/8"
N204 - D00	191	102	50	39	125	27	28	30 x 1.5	45	45	1/8"	38	3	0 - 6	1/4"

The company reserves the right to vary models and dimensions without notice.

Accessories for filters Series C, N, M regulators and lubricators

Mounting bracket - Fixing flange, screw for assembling
Take-off block
Pressure gauges, dia. 43, 53, 63

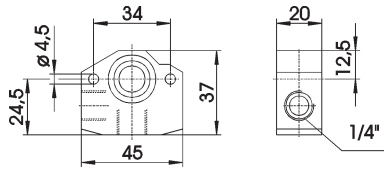

Take-off block (for C104)
Mod. C1 - B
(complete with 2 screws, Mod. C1-VB and 1 OR 2068)

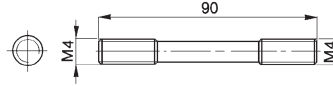

Tie-rod for assembling F + L (C104)
Mod. C1 - VL
(complete with 2 screws and 1 OR 2068)

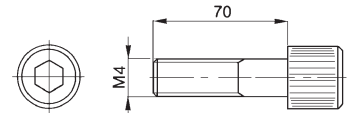

Screw for assembling F+B+R (C104)
Mod. C1 - VB
(spare part only)



Assembly O-ring F-L-R-D
for C104 mod.458-33/1 (OR 2068)
for C238-C202 mod. C238-R37 (OR 132)
and C401 mod. C401-F33 (OR 3150)
(spare part only).

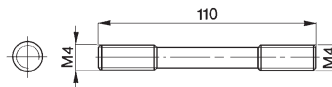

Tie-rod for assembling F+B+L (C104)
Mod. C1 - VBL
(complete with 2 screws and 1 OR 2068)

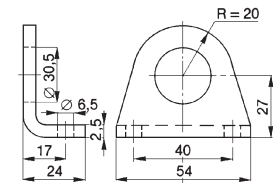

Mounting bracket R-D 1/4" 1/8" serie C-N-M
Mod. C114-ST

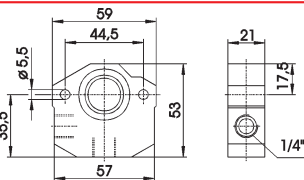

Take-off block (for C238 and C202)
Mod. C2-B
(complete with 2 screws, Mod. C2-VB and 1 OR 132)

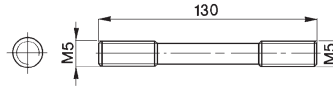

Tie-rod for assembling F+L (C238 and C202)
Mod. C2 - VL
(complete with 2 screws and 1 OR 132)

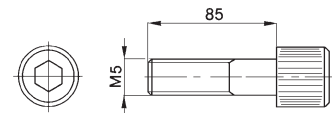

Screw for assembling F+B+R (C238 and C202)
Mod. C2 - VB
(spare part only)

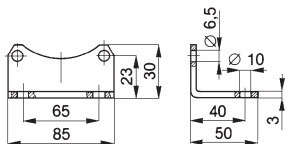

Mounting bracket (for C401)
Mod. C401-ST

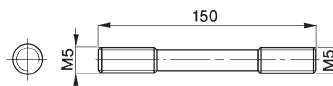

Tie-rod for assembling F+B+L (C238 and C202)
Mod. C2 - VBL
(complete with 2 screws and 1 OR 132)

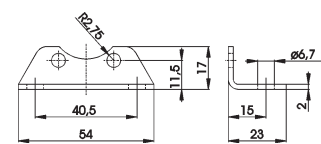

Mounting bracket (for N204 F-L)
Mod. N204-ST

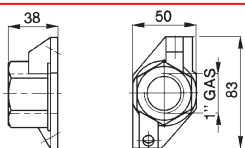

Fixing flange F-L-R-D (for C401)
Mod. C434-FL, 3/4" (right and left)
Mod. C401-FL, 1" (right and left)
(complete with 4 screws and 2 OR 3150)

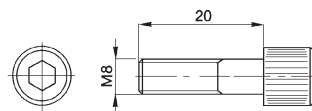

Screw for assembling F-L-R-D (for C401)
Mod. C4 - V
(complete with 2 screws and 1 OR 3150)
(spare part only)

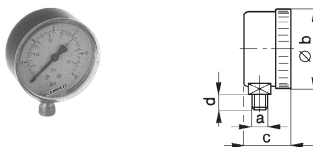

	a	b \varnothing	c	d
Mod. M 043 R12 1/8"	43	24	10	
Mod. M 053 R12 1/8"	53	27	10	
Mod. M 063 R12 1/4"	63	28	13	

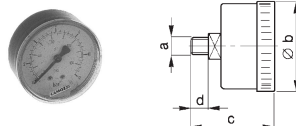

	a	b \varnothing	c	d
Mod. M 043 P12 1/8"	43	43	10	
Mod. M 053 P12 1/8"	53	47	10	
Mod. M 063 P12 1/4"	63	50	13	

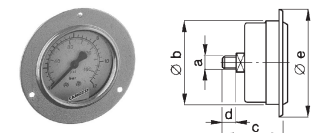

	a	b \varnothing	c	d	e \varnothing
Mod. M 043 F12 1/8"	43	43	10	57	
Mod. M 063 F12 1/4"	63	50	13	85	

6

Accessories for filters Series C, N, M regulators and lubricators

Mounting bracket - Fixing flange, screw for assembling
Take-off block
Pressure gauges, dia. 43, 53, 63

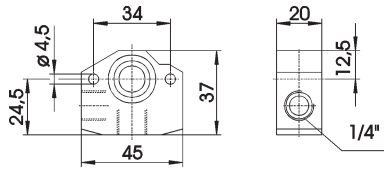

Take-off block (for C104)
Mod. C1 - B
(complete with 2 screws, Mod. C1-VB and 1 OR 2068)

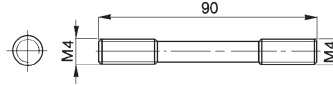

Tie-rod for assembling F + L (C104)
Mod. C1 - VL
(complete with 2 screws and 1 OR 2068)

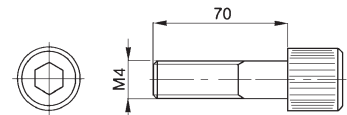

Screw for assembling F+B+R (C104)
Mod. C1 - VB
(spare part only)



Assembly O-ring F-L-R-D
for C104 mod.458-33/1 (OR 2068)
for C238-C202 mod. C238-R37 (OR 132)
and C401 mod. C401-F33 (OR 3150)
(spare part only).

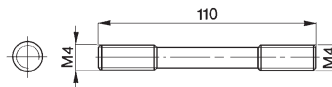

Tie-rod for assembling F+B+L (C104)
Mod. C1 - VBL
(complete with 2 screws and 1 OR 2068)

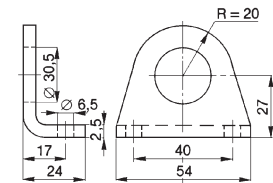

Mounting bracket R-D 1/4" 1/8" serie C-N-M
Mod. C114-ST

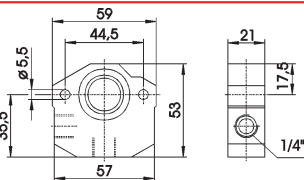

Take-off block (for C238 and C202)
Mod. C2-B
(complete with 2 screws, Mod. C2-VB and 1 OR 132)

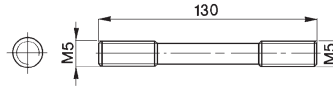

Tie-rod for assembling F+L (C238 and C202)
Mod. C2 - VL
(complete with 2 screws and 1 OR 132)

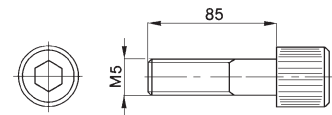

Screw for assembling F+B+R (C238 and C202)
Mod. C2 - VB
(spare part only)

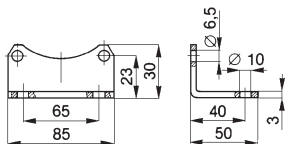

Mounting bracket (for C401)
Mod. C401-ST

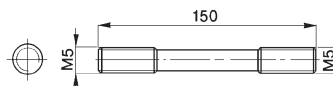

Tie-rod for assembling F+B+L (C238 and C202)
Mod. C2 - VBL
(complete with 2 screws and 1 OR 132)

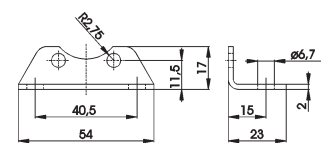

Mounting bracket (for N204 F-L)
Mod. N204-ST

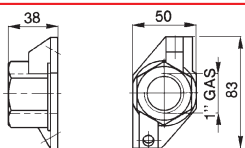

Fixing flange F-L-R-D (for C401)
Mod. C434-FL, 3/4" (right and left)
Mod. C401-FL, 1" (right and left)
(complete with 4 screws and 2 OR 3150)

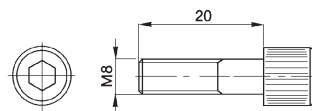

Screw for assembling F-L-R-D (for C401)
Mod. C4 - V
(complete with 2 screws and 1 OR 3150)
(spare part only)

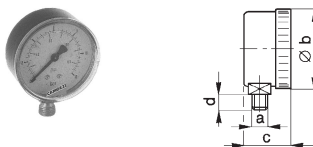

	a	b \varnothing	c	d
Mod. M 043 R12 1/8"	43	24	10	
Mod. M 053 R12 1/8"	53	27	10	
Mod. M 063 R12 1/4"	63	28	13	

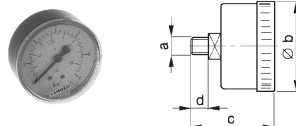

	a	b \varnothing	c	d
Mod. M 043 P12 1/8"	43	43	10	
Mod. M 053 P12 1/8"	53	47	10	
Mod. M 063 P12 1/4"	63	50	13	

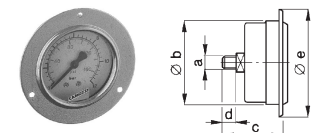

	a	b \varnothing	c	d	e \varnothing
Mod. M 043 F12 1/8"	43	43	10	57	
Mod. M 063 F12 1/4"	63	50	13	85	

6

Soft start valve

1202 - Soft Start electrically-operated Valve Series "C"

1202 - Soft Start pneumatically-operated Valve Series "C"

Ports 1/2" (compact)

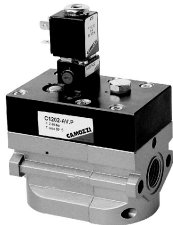

General data

construction	compact, poppet type
materials	aluminium body, NBR and DESMOPAN seals
ports	1/2"
weight	1.150 Kg
assembling type	in-line
operating pressure	0 ÷ 60 °C
finish	enamelled
Pneumatic data	
operating pressure	2 ÷ 10 bar
nominal flow	* Qn 3000 NI with ΔP1

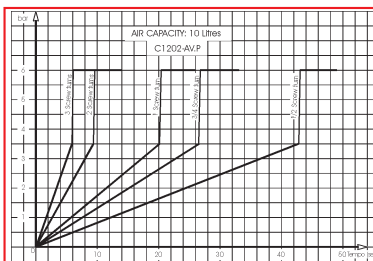

Variation in pressurisation time by use of the regulating screw.

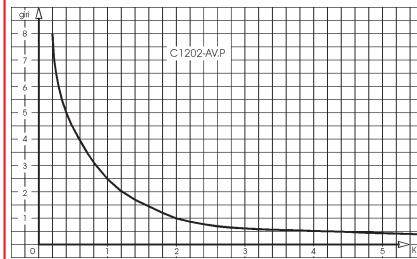

Constant K on the graph indicates the number of turns of the Regulating Screw required to obtain the required pressurisation time with an inlet pressure of 6 Bar. Variations of the inlet pressure can cause deviations of the pressuring time by ± 20 per cent.

$K = tV$ where:

V = Volume of the downstream system in litres

t = Desired pressuring time in seconds

EXAMPLE:

V = 20 litres

t = 16 seconds

$K = 16/20 = 0,8$

Using the graph, the value of K=0.8, shows that the number of turns of the Regulating Screw required to obtain the pressuring time of 16 seconds is approximately 3.

Long pressuring times (1/4 turn - 100 sec at 6 BAR with volume of 10 litres) will be obtained in the first turn of the Regulating Screw.

The soft start valve is needed to prevent harming people or equipment when pressurizing a pneumatic system equipped with cylinders.

The specifications of this component allow the gradual pressurization of a pneumatic system.

Pressure is gradually increased until 50% of the system pressure is reached. System pressure then increases to 100% of the set pressure in a very short time. The natural location of the slow start valve is after the F.R.L.; in fact, the flanging allows for perfect adaptability with 1/2" Series "C".

Two different types of slow start valves are available:

- electrically-operated soft start valves
- pneumatically-operated soft start valves

For electrically operated soft start valves, a 3-way normally closed solenoid valve mod. A631-AC2-A00 is used. This valve starts only when the electrical switch is operated. For pneumatically operated soft start valves, the base A631-AC2-AVPC on which a Super Rapid fitting ø 4 is built, is used. This Super Rapid fitting receives the signal produced by a NC 3-way manually operated valve which acts as a general switch. On request, a pressure gauge can be assembled in place of tap Mod. 2611-1/8" located in the upper part near the solenoid valve or the pneumatic drive.

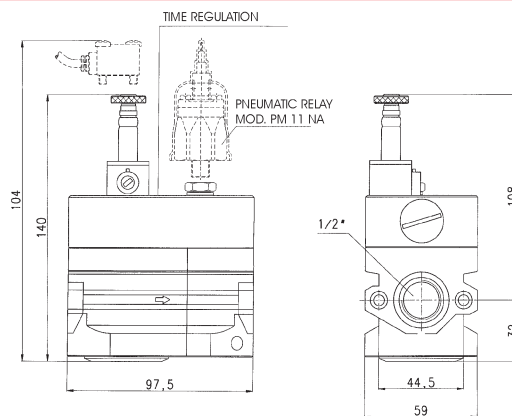
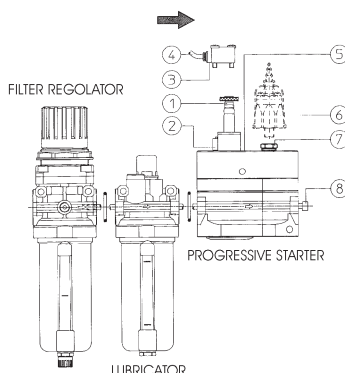

Figure 1 shows the solenoid valves' (1) operation scheme. This valve is also provided with a manual drive (2) that makes the setting easier. Instead of the tap (7), it is possible to assemble a suitably calibrated pressure gauge (6) that allows the installation to start only when the selected pressure has been reached.

A rapid exhaust valve built in on to the soft valve end cap allows the pressure to be removed from the pneumatic installation. The regulation screw (5) is used to set the inlet pressure allowing the protection of both its operators and its mechanical parts.



AVP electric pilot	1	Solenoid valve A631 - AC2 - 000
	2	Manual override
AVP pneumatic pilot	3	End - cover pneumatic pilot A631 - AC2 - AVPC
	4	Input pneumatic pilot
AVP electric and pneumatic pilot	5	Regulation screw
	6	Pneumatic relay PM 11 NA
	7	Cap 2611 - 1/8
	8	Assembly screw M5 x 160

